

ZONE 4a & 4b - NORTH VISUAL SCREEN PLANTING  
 ZONE 4c - REFORESTATION COMPENSATION

**PROJECT**  
 West Carleton Environmental Centre  
 Site Plan Approval  
 Landscape Development

2349 to 2432 Carp Road

**CLIENT**  
**WASTE MANAGEMENT**  
 2301 Carp Road  
 Ottawa ON K0A 0Z8  
 www.WMCanada.com

**CONSULTANT**  
 AECOM Canada Ltd.  
 302-1150 Morrison Drive  
 Ottawa, ON  
 613.820.8282 tel 613.820.8338 fax  
 www.aecom.com

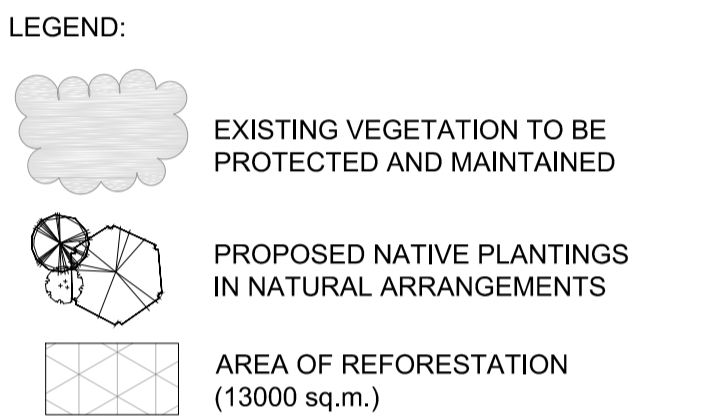

**PLANT LIST - ZONE 4a & 4b NORTH LANDSCAPE AREA**

ID Key	Botanical Name	Common Name	Size	Qty.	Remarks
<b>Trees</b>					
Ab	Abies balsamea	Balsam Fir	1.2m HL, WB	65	Straight trunk, full, well branched, bushy symmetrical form
Ar	Acer rubrum	Native Red Maple	250cm HL, BB	51	Straight trunk, well developed side branching, symmetrical form
As	Acer saccharum	Sugar Maple	250cm HL, BB	55	Straight trunk, well developed side branching, symmetrical form
Bp	Betula papyrifera	White Birch	250cm HL, BB	58	3 stem clump, straight trunk, well developed side branching
Pg	Picea glauca	White Spruce	1.2m HL, WB	61	Straight trunk, full, well branched, bushy symmetrical form
Ps	Pinus strobus	Eastern White Pine	1.2m HL, WB	34	Straight trunk, full, well branched, bushy symmetrical form
Ta	Tilia americana	American Basswood	250cm HL, BB	10	Straight trunk, well developed side branching, symmetrical form
To	Thuja occidentalis	Eastern White Cedar	1.2m HL, BB	43	Swamp cedar, well developed side branching, symmetrical form
Note: Deciduous tree trunk size to be 40mm Cal. min. (field grown stock)					
<b>Shrubs</b>					
Ac	Amelanchier canadensis	Downy Serviceberry	1.0m HL, Potted	19	Well branched, bushy form, min. 5 canes
Sc	Sambucus canadensis	Elderberry	1.0m HL, Potted	27	Well branched, bushy form, min. 7 canes
Pv	Prunus virginiana	Choke Cherry	1.0m HL, Potted	29	Well branched, bushy form, min. 5 canes
Vi	Viburnum lentago	Nannyberry	1.0m HL, Potted	64	Well branched, bushy form, min. 5 canes

**PLANT LIST - ZONE 4c REFORESTATION AREA**

ID Key	Botanical Name	Common Name	Size	Qty.	Remarks
<b>Trees</b>					
Ar2	Acer rubrum	Native Red Maple	300mm HL, BR	910	Seedling, Planted 2.0m O/C
As2	Acer saccharum	Sugar Maple	300mm HL, BR	910	Seedling, Planted 2.0m O/C
Bp2	Betula papyrifera	White Birch	300mm HL, BR	910	Seedling, Planted 2.0m O/C
Ps2	Pinus strobus	Eastern White Pine	300mm HL, BR	910	Seedling, Planted 2.0m O/C
Pb2	Populus balsamifera	Balsam Poplar	300mm HL, BR	910	Seedling, Planted 2.0m O/C
Pt2	Populus tremuloides	Trembling Aspen	300mm HL, BR	910	Seedling, Planted 2.0m O/C
To2	Thuja occidentalis	Eastern White Cedar	300mm HL, BR	910	Seedling, Planted 2.0m O/C
1) Growing medium for reforestation area to be conditioned with organic matter and topsoil. Ground is to be tilled to mitigate compaction. Prepared soil is to be a minimum depth of 200mm. 2) Surface after planting is to receive an application of approved cover crop seed mixture broadcasted. 3) Reforestation area is to be covered with 75mm of wood mulch (product of chipping existing vegetation removed)					
<b>SEED MIXTURE - Cover Crop for Reforestation Area</b>					
Botanical Name		Common Name			
Lolium multiflorum		Annual Rye Grass			
Seeding Rate: 22 kg/hectare (20 lbs/acre)					

**REVISION DATE**  
 1. RE-ISSUED FOR SPA SUBMISSION 21/07/15  
 2. RE-ISSUED FOR SPA SUBMISSION 10/08/15  
 3. RE-ISSUED FOR SPA SUBMISSION 11/09/15  
 4. RE-ISSUED FOR SPA SUBMISSION 01/10/15

APPROVED  REFUSED   
 THIS DAY OF \_\_\_\_\_, 20\_\_\_\_  
 \_\_\_\_\_  
 DERRICK MOODIE, MANAGER  
 DEVELOPMENT REVIEW, RURAL SERVICES

**PROJECT NUMBER**  
 60430948

**DRAWING TITLE**  
 North End Visual Screening  
 Zone 4

**DRAWING DATE**  
 February 2015

L7